

To access the electronic user manual use the corresponding QR code or link below

Language

ABOUT US NEWS SCANNERS BIO DETECTION ODM IR CONTACT US

FEATURES SPECIFICATIONS **DOWNLOADS**

If there are any issues regarding the download, please refer to the following link:
[How to Download software from Scanace Website.pdf](#)

Manual [Download](#)

Troubleshooting [Download](#)

Driver for Mac OS 10.7 or higher [Download](#)

Driver for Windows 7/8/10/11 32 & 64 bit [Download](#)

Firmware Update [Download](#)

<https://www.scanace.com>



Follow us on Facebook



<https://www.facebook.com/Pacific-Image-Electronics-395587123830570/>

PowerFilm Plus

Start Here

Please read these instructions before using your product

1. Unpacking and How to insert the film feed holder

Unpack contents and remove protective tape.

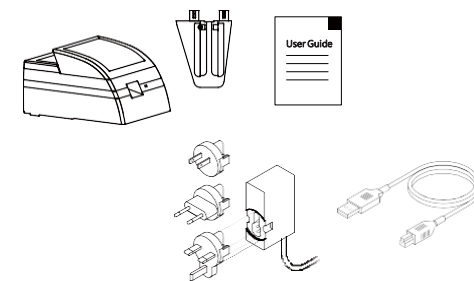

Contents:
PowerFilm Scanner, film feeder, universal AC adapter with interchangeable plug (US/EU/UK), USB 2.0 cable.

If any items are missing, please contact your nearest dealer or place of purchase.

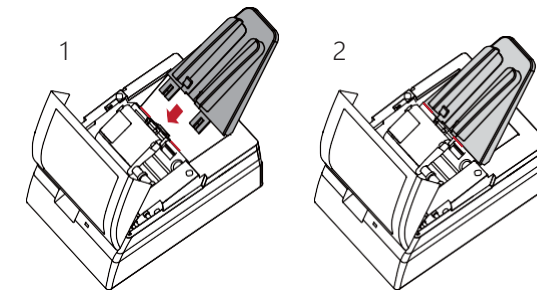

Please be sure the film feeder is inserted properly and secure before proceeding.

2. Software installation

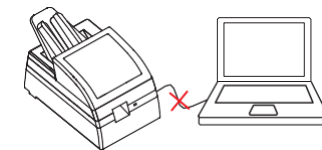

A DO NOT CONNECT the scanner before installing the software. If you see a "Found New Hardware" screen, click "Cancel" and disconnect the scanner.

B Please download the software from <https://www.scanace.com>. Double-click the software program to finish installation.

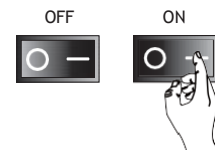

C After installing the software, locate the power switch on the lower right rear side of the scanner. Make sure the scanner is TURNED OFF. Plug the AC adapter into an AC power source FIRST before plugging it into the scanner. Then switch power to the "ON" position.

3. Organizing your filmstrips

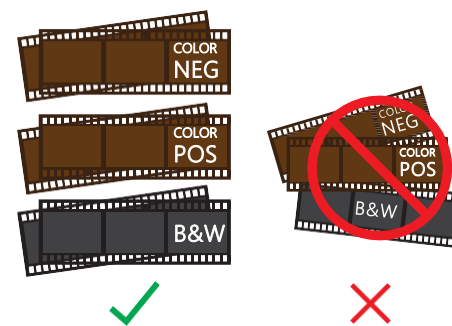

Sort your filmstrips by type—keeping color negatives, color positives and B&W filmstrips in separate batches. You can only scan films of the same type in each session, DO NOT MIX.

You can scan 1-10 filmstrips at a time, of 2-6 frames in length. Please note PowerFilm cannot process individual frames. when inserting, film strips should be placed with the emulsion (dull) side facing down.

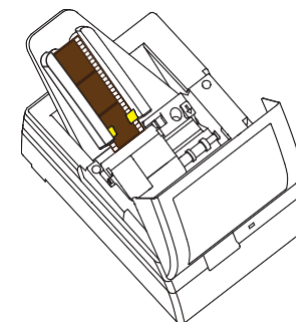

PowerFilm Plus

Start Here

Please read these instructions before using your product

4. Cleaning and checking your filmstrips

If films have not been stored in the plastic sleeve from developer, or if there is dust on them, please clean using a soft lint free cloth and isopropyl alcohol (concentration of 98% or greater)

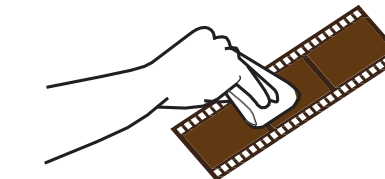

Please only insert filmstrips that are in good condition. Do not use film that is warped, stained, crumpled, curled up or damaged in any way.

